



High Resolution Linear Displacement Transducer

ILT 10 Series



Main Characteristics

Parameters

| | |
|---|---|
| Electrical Stroke | +/- 1 mm |
| Supply voltage | 2 to 7 Vrms from 2.5 to 10 kHz |
| Current Consumption | 33 mA at 3 Vrms |
| Resolution | <0.15 μm (with suggested signal conditioning) |
| Null position voltage | <0.6% of FS |
| Linearity | <0.25% of FS |
| Length | 20 mm |
| Diameter | 10 mm |
| Primary DC resistance | 90 Ohm |
| Temperature coefficient of Voltage output | <0.02% of FS/degC (drift in voltage measured from full stroke position) |
| Operational Temperature | - 40°C to 85°C |
| Case Material | 400 Series Stainless Steel |
| Push Rod | 316 Stainless Steel with M3 x 10 threading |
| Dielectric Strength | 100 VDC |
| Insulation Resistance | 10M Ω |
| IP Rating | IP67 |
| Cabling | Available with twisted leads or shielded cables (4/5/6 wires with both options) |

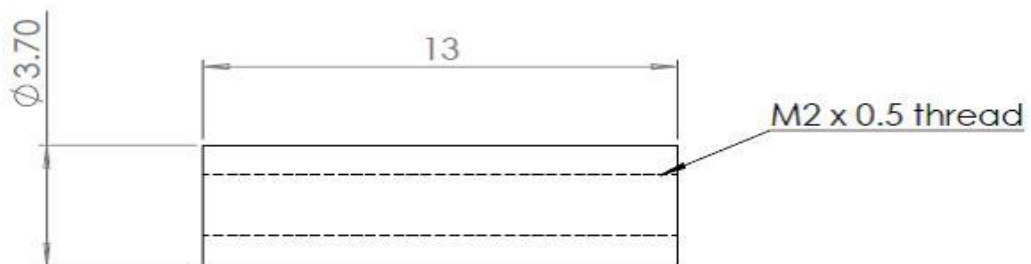
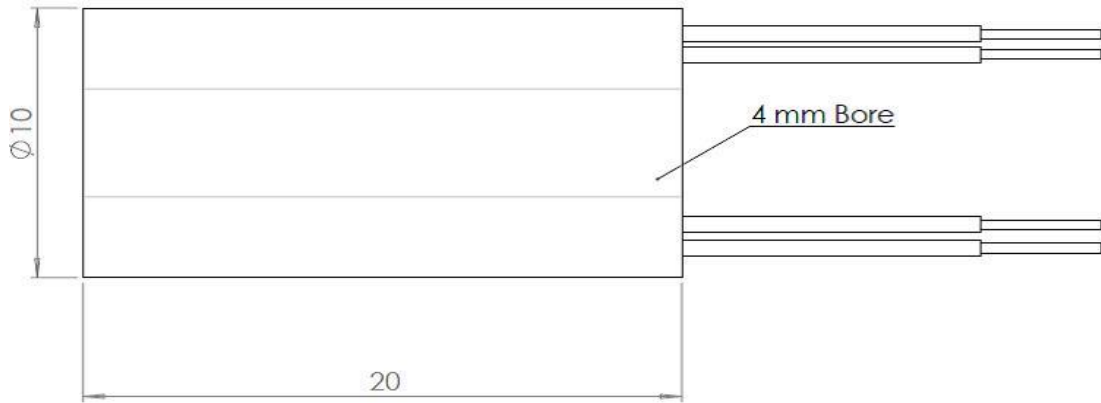

***various adaptations possible to be made to push road as per customer requirement**